

Beo4

Guide

Using your Beo4 remote control, 4

Beo4 buttons in detail, 6

- Daily and advanced operation with Beo4 buttons

Customise Beo4, 9

- Set up Beo4
- Add an extra 'button'
- Move extra 'buttons'
- Remove an extra 'button'
- Configure Beo4 for use with another audio or video system

Maintenance, 16

- Cleaning the Beo4
- Changing the batteries

Technical specifications, features and the use thereof are subject to change without notice.

This product is in conformity with the provisions of the Directives 1999/5/EC and 2006/95/EC.



Using your Beo4 remote control

The Beo4 display tells you which source you are operating. It is also used for calling up extra "buttons" for different functions or sources.

Source buttons and buttons for recording.

Number keys; and buttons for Teletext and on-screen menus.

Control buttons within the star-shaped button.

Volume, stop and exit buttons; and LIST button for calling up extra "buttons" in the Beo4 display.

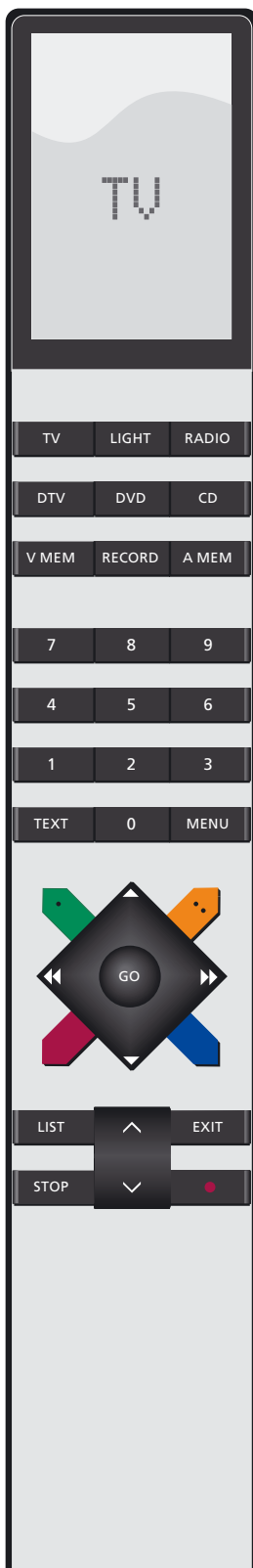

The Beo4 is a hand-held remote control which gives easy access to remote operation of your Bang & Olufsen audio and/or video system.

Daily operations are carried out by pressing a single button on the Beo4, or by pressing a few buttons in a logical and straightforward sequence.

The display on Beo4 keeps you informed of which source you are operating, such as TV, RADIO, a DVD player, or even the lights...

But the Beo4 remote control incorporates more functions than just the actual buttons: Extra sources can be switched on, and additional functions can be obtained via the display. "Buttons" for these functions can be called up on the Beo4 display via the LIST button.

Whether you use the Beo4 buttons for daily operation, or call up extra "buttons" for functions or sources in the display, you will find that Beo4 remote operation is easy ...

On the Bang & Olufsen web-site you can find a lexicon of extra Beo4 buttons.

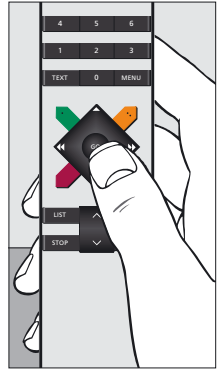

The Beo4 remote control – you will find all the buttons you need for daily operation centred in and around the star-shaped button.

Beo4 buttons in detail ...



Daily and advanced operation with Beo4 buttons

The buttons on the Beo4 remote control are conveniently grouped for daily operation ...

Source buttons ... TV, DTV (SAT*), VMEM (VTAPE*), RADIO, DVD, CD, A MEM (ATAPE*), and LIGHT are used for switching on your Bang & Olufsen audio and video products, other audio/video integrated systems and the Bang & Olufsen light control. Some externally connected products may have to be switched on via the LIST button and subsequent relevant "buttons" or cues shown in the Beo4 display.

RECORD button ... is situated close to the source buttons to enable easy recording on a video or audio recorder.

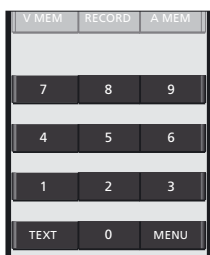

Number keys ... 0 through to 9 are used whenever you have to key in numbers, for example, to select an exact TV or radio program number, to select Teletext pages, to select specific tracks on a CD or DVD, and to select a specific audio or video recording.

TEXT and MENU buttons ... gives access to Teletext on your Bang & Olufsen TV and calls up the on-screen menus for your Bang & Olufsen video products.

NOTE! Buttons marked with an * apply only to previous versions of the Beo4 remote control.

Control buttons within the star-shaped button ...

▲ and ▼ ... allow you to step through program numbers or tracks. On some audio systems, they act as On or Off buttons respectively for a Random, Repeat or Edit function.

◀◀ and ▶▶ ... allow you to wind through or change between recordings or discs. The buttons have different functions depending on your Bang & Olufsen audio or video system. Refer to the Guide enclosed with your system for further information.

GO button ... is used for accepting various types of operations; and to resume playing the source which is shown in the Beo4 display.

Coloured buttons ... are for special operations. It will be explained in the Guide for your Bang & Olufsen product when and how to use the buttons.



Volume, stop and exit buttons; and LIST button for calling up extra "buttons" in the Beo4 display ...

Volume button ... ^ and v in the centre turns the sound in the loudspeakers up or down.

Press the volume button right on the middle to mute the speakers completely, press the button again to bring the sound back.

STOP button ... is used for various stop functions, for example, to stop playback on a source.

EXIT button ... exits Beo4 display operation; and removes on-screen menus.

LIST button ... pressing it repeatedly displays extra "buttons" for functions or sources in the Beo4 display.

Standby button • ... the red standby button switches your Bang & Olufsen system off.



The Beo4 buttons give direct remote control of a large number of functions, and the Beo4 display gives you access to even more functions.

On the Bang & Olufsen web-site you can find a lexicon of extra Beo4 buttons.

Whenever a source is displayed on Beo4 (TV, RADIO, etc.), you can press the LIST button and bring up extra functions in the display to help you operate that source, just as if you were calling up extra buttons. You can also switch on extra equipment connected to your television.

You can customise a new Beo4 to suit your television, and change the order in which these extra functions appear when you call them up.

Note that Beo4 contains a list of all of Bang & Olufsen's extra audio and video functions, but only those functions supported by the Bang & Olufsen product work when you call them up in the Beo4 display.

Set up Beo4

If you buy a new Beo4 you can set it up for your television or also.

- > Press and hold the standby button down.
- > Press **LIST** to get access to the Beo4 setup function.
- > Let go of both buttons. **ADD?** appears in the display.
- > Press **LIST** repeatedly to display **CONFIG?** on Beo4.
- > Press **GO** to be able to select the type of configuration.
- > Press **LIST** repeatedly to display **VIDEO?** on Beo4.
- > Press **GO** to get access to the video configuration.
- > Press **LIST** repeatedly to display **VIDEO 4** on Beo4.
- > Press **GO** to store the configuration.
- > **STORED** appears, indicating that the configuration has been stored. You leave the Beo4 setup function automatically.

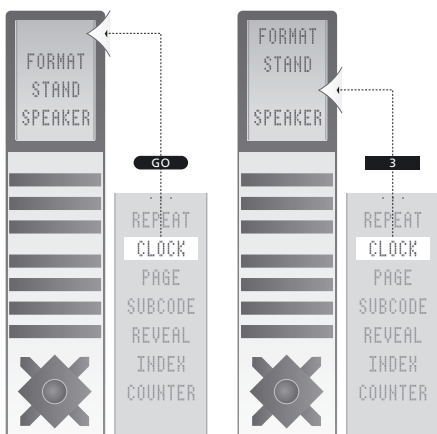

Add an extra 'button' to Beo4, either to the top of the list or to a specific position.

Add an extra 'button'

When you add a new function to the Beo4 list, you can then bring up this new 'button' in the Beo4 display.

- > Press and hold the standby button down.
- > Press **LIST** to get access to the Beo4 setup function.
- > Let go of both buttons. **ADD?** appears in the display.
- > Press **GO** to bring up the list of available 'buttons' to add from. The first 'button' appears in the display, it flashes on and off.
- > Press **▲** or **▼** to move forwards or backwards in the list of all extra 'buttons'.
- > Press **GO** to add and place the 'button' on its preset position or as the first 'button' in the list, or ...
- > ... press **1 – 9** to insert the 'button' at a specific position in the list.
- > **ADDED** appears, indicating that the 'button' has been added. You leave the Beo4 setup function automatically.

Move extra 'buttons', either to the top of the list or to a specific position.

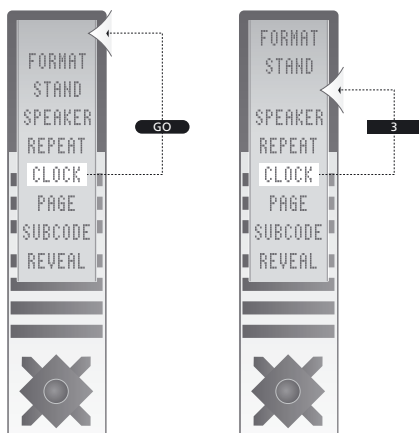

Move extra 'buttons'

You can rearrange the order in which the extra 'buttons' appear when you press LIST.

- > Press and hold the standby button down.
- > Press **LIST** to get access to the Beo4 setup function.
- > Let go of both buttons. **ADD?** appears in the display.
- > Press **LIST** repeatedly to display **MOVE?** on Beo4.
- > Press **GO** to bring up the list of extra 'buttons'. The first 'button' appears in the display.
- > Press **▲** or **▼** to move forwards or backwards in the list of extra 'buttons'.
- > Press **GO** to move and place the displayed 'button' as the first in the list, or ...
- > ... press **1 – 9** to move the 'button' to a specific position in the list.
- > **MOVED** appears, indicating that the 'button' has been moved. You leave the Beo4 setup function automatically.

Remove an extra 'button'

You can remove any of the extra 'buttons' that are available when you press LIST.

- > Press and hold the standby button down.
- > Press **LIST** to get access to the Beo4 setup function.
- > Let go of both buttons. ADD? appears in the display.
- > Press **LIST** repeatedly to display REMOVE? on Beo4.
- > Press **GO** to bring up the list of extra 'buttons'. The first 'button' appears in the display.
- > Press ▲ or ▼ to move forwards or backwards in the list of extra 'buttons'.
- > Press **GO** to remove the 'button' shown in the display.
- > REMOVED appears, indicating that the 'button' has been removed. You leave the Beo4 setup function automatically.

Configure Beo4 for use with another audio or video system

Your Beo4 is configured for VIDEO4 from the factory, but you can configure Beo4 for use with any type of Bang & Olufsen audio or video system.

To be able to reconfigure Beo4 ...

- > Press and hold the standby button down.
- > Press **LIST** to get access to the Beo4 setup function.
- > Let go of both buttons. ADD? appears in the display.
- > Press **LIST** repeatedly to display CONFIG? on Beo4.
- > Press **GO** to be able to select the type of configuration – video or audio.
- > Press **LIST** until VIDEO? or AUDIO? appears in the display.
- > Press **GO** to get access to video or audio configurations.
- > Press **LIST** until the configuration you want appears in the display.
Or, press any of the control buttons, ▲, ▼, ◀ or ▶ to move forwards or backwards in the list of available configurations.
- > Press **GO** to store the configuration shown in the display.

When STORED appears in the display, the configuration has been changed and you then leave the Beo4 setup automatically ...

VIDEO1: BeoVision 9, BeoVision 5, BeoVision 4, BeoSystem 1, BeoVision 3 – 32-inch screen, BeoVision Avant, BeoCenter AV5, BeoCenter AV 9000, Earlier BeoVision MX models
VIDEO2: BeoVision 6, BeoVision 3 – 28-inch screen, BeoVision 1, BeoVision 1 Link, BeoCenter 1, BeoVision MX4200/8000
VIDEO3: Video products for the American Taiwanese markets
VIDEO4: BeoVision 8, BeoSystem 3
AUDIO1: Audio systems other than BeoSound 9000
AUDIO2: BeoSound 9000

AUDIO
BASIC: all audio systems other than BeoSound 9000
BS9000: BeoSound 9000

VIDEO
AVANT: BeoVision Avant
AVANTUS: BeoVision Avant US
AV5: BeoCenter AV5
BC1: BeoCenter 1
BV1: BeoVision 1
MX: BeoVision MX
NONE: For audio setups.
 No video functions are included

Other options than those listed here may appear in the display when you select VIDEO? or AUDIO?. These other options are listed below. Refer to the Beo4 lexicon on our web-side for further information.

In order to use teletext on a television you have set to Option 4, you must set up Beo4 to 'VIDEO 3', but this limits the Beo4 functions that can be used with televisions set to other Options. For further information, refer to the Guide for the television.

Maintenance ...

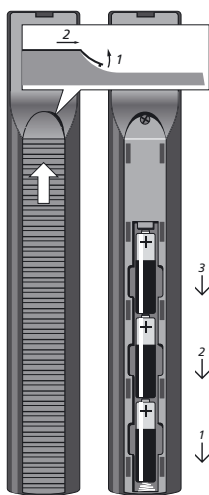

CAUTION! Do not expose batteries to excessive heat such as sunshine, fire or the like!

Cleaning the Beo4...

Wipe the Beo4 remote control with a soft, lint-free, wet cloth which is wrung firmly.

Changing the batteries

When BATTERY appears in the Beo4 display, it is time to change the batteries in the remote control.

The Beo4 requires three batteries (placed under the lid on the back). We recommend that you use 1.5 volt (size AAA) Alkaline batteries only.

Replace the batteries as shown on the next page.

When you have replaced the batteries, you must wait for about 10 seconds until the display reads TV. The Beo4 remote control is then ready to operate again.

Note: We recommend that you keep a finger on top of the batteries until the lid is replaced.

English (English)

Electrical and electronic equipment, parts and batteries marked with this symbol must not be disposed of with normal household wastage, it must be collected and disposed of separately to protect the environment.

Your Bang & Olufsen retailer will advise you of the correct way of disposal in your country.

If a product is too small to be marked with the symbol, it will appear in the User Guide, on the Guarantee certificate, or on the packaging.

For the US-market only!

NOTE: This equipment has been tested and found to comply with the limits for a class B digital device, pursuant to part 15 of the FCC Rules. These limits are designed to provide reasonable protection against harmful interference in a residential installation.

This equipment generates, uses and can radiate radio frequency energy and, if not installed and used in accordance with the instructions, may cause harmful interference to radio communications. However, there is no guarantee that interference will not occur in a particular installation. If this equipment does cause harmful interference to radio or television reception, which can be determined by turning the equipment off and on, the user is encouraged to try to correct the interference by one or more of the following measures:

- Reorient or relocate the receiving antenna.
- Increase the separation between the equipment and receiver.
- Connect the equipment into an outlet on a circuit different from that to which the receiver is connected.
- Consult the retailer or an experienced radio/TV technician for help.

For the Canadian market only!

This class B digital apparatus meets all requirements of the Canadian Interference-Causing Equipment Regulations.



This product is in conformity with the provisions of the Directives 2004/108/EC and 2006/95/EC.

All Bang & Olufsen products comply with applicable environmental legislation throughout the world.

