

BeoLab 4 PC

Guide

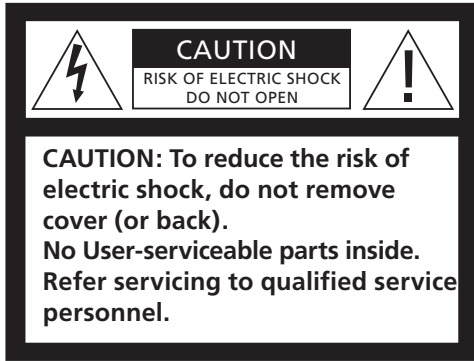

WARNING: To reduce the risk of fire or electric shock, do not expose this appliance to rain or moisture. Do not expose this equipment to dripping or splashing and ensure that no objects filled with liquids, such as vases, are placed on the equipment.

To completely disconnect this equipment from the AC Mains, disconnect the power supply cord plug from the AC receptacle.



The lightning flash with arrowhead symbol within an equilateral triangle, is intended to alert the user to the presence of un-insulated “dangerous voltage” within the product’s enclosure that may be of sufficient magnitude to constitute a risk of electric shock to persons.



The exclamation point within an equilateral triangle is intended to alert the user to the presence of important operating and maintenance (servicing) instructions in the literature accompanying the product.

When you have finished setting up the loudspeakers as described on the following pages, connect the entire system to the mains.

Cleaning the loudspeaker

You can clean the speaker panels with a vacuum cleaner set to the lowest suction level. Clean the other surfaces using a soft, lint-free cloth which you have dipped in lukewarm water and wrung firmly.

Never use alcohol or other solvents to clean any parts of the loudspeaker!

Switching on and off

If you have set the LINE IN MODE switch to AUTO, the loudspeakers automatically switch on when they receive an input signal – indicated by green indicator lights. When you switch off your system, the loudspeakers will, after a few minutes, automatically switch to standby – indicated by red indicator lights.

However, if you have set the LINE IN MODE switch to ON, the loudspeakers are always switched on, even when you switch off your system.

In either setting of the LINE IN MODE switch, the loudspeakers can only be switched off completely by disconnecting them from the mains supply.

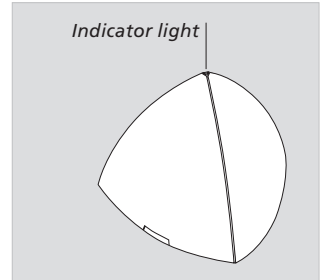

NOTE! Prolonged listening at high volume levels may cause hearing damage.

Set up the loudspeakers

We recommend that you follow this procedure:

- Disconnect your system from the mains.
- Connect the loudspeakers and set the LINE IN MODE switch on each loudspeaker as explained in 'Cable connections' (pp. 6–7).
- Connect the entire system to the mains again.

The loudspeaker must be placed standing upright on its base, or fastened to one of the optional accessories. Make the connections, and set the switch before you fasten the loudspeaker to one of the accessories.

Cautions

- Make sure that the loudspeakers are placed and connected in accordance with the instructions in this Guide. To prevent injury, use Bang & Olufsen approved stands and wall brackets only!
- Do not attempt to open the loudspeakers. Leave such operations to qualified service personnel! The speaker panels, however, may be removed for cleaning.
- The loudspeaker is designed for indoor use in dry, domestic environments only, and for use within a temperature range of 10–40° C (50–105° F).
- For optimum sound quality, do not place the loudspeaker enclosed in, for example, a small bookcase. Leave a minimum of 20 cm (8") free space at the sides, and never place anything directly in front of the loudspeaker.
- Do not block the sound emitting from the bass reflex port at the bottom of the loudspeaker.
- Place the loudspeaker with its front (the Bang & Olufsen name plate) facing your favourite listening position.

Loudspeaker front and side panels

Each loudspeaker is equipped with *one front panel and two side panels*. These panels are fastened to the loudspeaker with three small pegs on the rear. The front panel is marked with a Bang & Olufsen name plate.

To remove the panels, for example for cleaning, just pry the three pegs in each panel free of the corresponding holes (A–B) in the loudspeaker. Fasten the panels again by inserting the three pegs into the corresponding holes in the front and the sides of the loudspeaker.

Note: The product identification and CE labels are placed on the loudspeaker body behind the side panels.

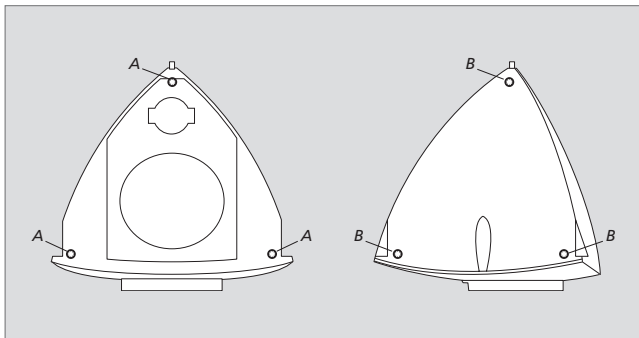

Cable connections

The loudspeakers are intended for use with a personal computer. They may also be used with non-Bang & Olufsen audio or video systems.

About the LINE IN MODE switch ...

The switch has two settings: ON and AUTO. We recommend that you set the switch to the same position on each loudspeaker.

When set to ON, the loudspeakers will not automatically switch to standby when the sound signal disappears. In this case, we recommend that you switch off at the mains supply, when not using the system. When set to AUTO, the loudspeakers automatically switch on when you switch on the system. When you switch off the system, the loudspeakers will, after a few minutes, switch to standby.

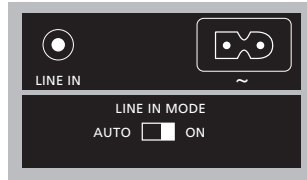

The sockets and the switch are located in the base of each loudspeaker.

Connection to personal computers

Use the enclosed connector to connect the computer sound card output to each of the loudspeakers.

As the sound signal from a computer may vary (not constantly on), we recommend that you set the LINE IN MODE switch to ON. This will prevent the loudspeakers from switching off and on every few minutes.

Connection to audio or video systems

Connect the system to the LINE IN socket on each loudspeaker (mini-jack – mono).

Set the LINE IN MODE switch to AUTO.

LINE IN connections: *Output from computer sound cards often carry both the left and right sound channels in one socket. Therefore, use the enclosed connector when connecting the loudspeakers to a personal computer (fig 1). Connect the plug marked **L** to the left loudspeaker, and the plug marked **R** to the right loudspeaker.*

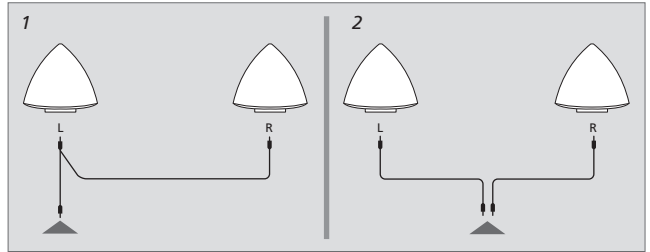

If you connect the loudspeakers to, for example, a non-Bang & Olusen audio or video system with separate connections for the left and right sound channels, make the connections as shown in fig. 2.

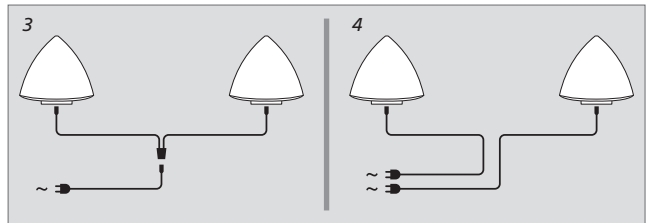

Mains connections: *Depending on the type of mains supply connector enclosed with your loudspeakers, connect each loudspeaker to the mains as shown in either fig. 3 or fig. 4.*

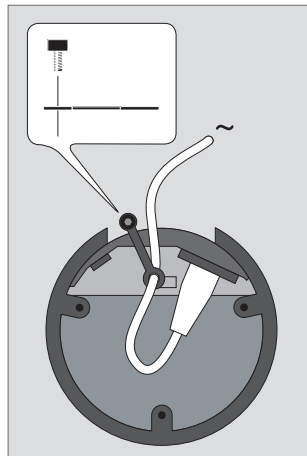

Cable Clamp: *For safety reasons, the mains lead to each loudspeaker must be secured with the cable clamp provided.*



Waste Electrical and Electronic Equipment (WEEE) – Environmental protection

The European Parliament and the Council of the European Union have issued the Waste Electrical and Electronic Equipment Directive. The purpose of the Directive is the prevention of waste of electrical and electronic equipment, and to promote the reuse and recycling and other forms of recovery of such waste. As such the Directive concerns producers, distributors and consumers.

The WEEE directive requires that both manufacturers and end-consumers dispose of electrical and electronic equipment and parts in an environmentally safe manner, and that equipment and waste are reused or recovered for their materials or energy.

Electrical and electronic equipment and parts must not be disposed of with ordinary household refuse; all electrical and electronic equipment and parts must be collected and disposed of separately.

Products and equipment which must be collected for reuse, recycling and other forms of recovery are marked with the pictogram shown.

When disposing of electrical and electronic equipment by use of the collection systems available in your country, you protect the environment, human health and contribute to the prudent and rational use of natural resources. Collecting electrical and electronic equipment and waste prevents the potential contamination of nature with the hazardous substances which may be present in electrical and electronic products and equipment.

Your Bang & Olufsen retailer will assist with and advise you of the correct way of disposal in your country.

For the US-market only!

NOTE: This equipment has been tested and found to comply with the limits for a class B digital device, pursuant to part 15 of the FCC Rules. These limits are designed to provide reasonable protection against harmful interference in a residential installation.

This equipment generates, uses and can radiate radio frequency energy and, if not installed and used in accordance with the instructions, may cause harmful interference to radio communications. However, there is no guarantee that interference will not occur in a particular installation. If this equipment does cause harmful interference to radio or television reception, which can be determined by turning the equipment off and on, the user is encouraged to try to correct the interference by one or more of the following measures:

- Reorient or relocate the receiving antenna.
- Increase the separation between the equipment and receiver.
- Connect the equipment into an outlet on a circuit different from that to which the receiver is connected.
- Consult the retailer or an experienced radio/TV technician for help.

For the Canadian market only!

This class B digital apparatus meets all requirements of the Canadian Interference-Causing Equipment Regulations.

CE This product fulfils the conditions stated in the EEU directives 89/336 and 73/23.

Technical specifications, features and the use thereof are subject to change without notice!

Til det norske marked!

Mekaniske og elektroniske komponenter i produktene slites ved bruk. Det må derfor påregnes reparasjoner og utskiftning av komponenter innenfor kjøpslovens reklamasjonstid, som må regnes som vedlikehold av produktene. Slik vedlikehold gir ikke grunnlag for å rette mangelskrav mot forhandler eller leverandør, og må bekostes av kjøper.

